

## Specifications and types

Suction fittings	2" f BSPP o DN 50 - NPT
Delivery fittings	1" 1/2 m BSPP o DN 40 - NPT
Max. flow rate	35 m <sup>3</sup> /h
Min. flow rate	4 m <sup>3</sup> /h
Max. head	24 m
Viscosity up to	150 cps

 PLASTIC MATERIAL  
PP

 PLASTIC MATERIAL  
PVDF

## STANDARD ELECTRIC MOTOR:

## Kw 2,2 HP 3

- Constructive Form B3+B5
- RPM 2900
- Three-phase 230/400 V - 50/60 HZ
- 2 Poles IE3 Protection IP55
- Ambient temperature -30°C + 45°C

## Kw 3 HP 4

- Constructive Form B3+B5
- RPM 2900
- Three-phase 230/400 V - 50/60 HZ
- 2 Poles IE3 Protection IP55
- Ambient temperature -30°C + 45°C

## Kw 4 HP 5,5

- Constructive Form B3+B5
- RPM 2900
- Three-phase 230/400 V - 50/60 HZ
- 2 Poles IE3 Protection IP55
- Ambient temperature -30°C + 45°C

## Kw 2,2 HP 3

- Constructive Form B3+B5
- RPM 2900
- Single-phase
- Ambient temperature -30°C + 45°C

## Kw 3 HP 4

- Constructive Form B3+B5
- RPM 2900
- Single-phase
- Ambient temperature -30°C + 45°C

## IMPELLER M. 2,2 Kw (3 HP) M. 3 Kw (4 HP) M. 4 Kw (5,5 HP)

Ø 134 mm (Standard)	up to 1,1 g/cm <sup>3</sup>	up to 1,5 g/cm <sup>3</sup>	up to 1,8 g/cm <sup>3</sup>
Ø 122 mm	up to 1,4 g/cm <sup>3</sup>	up to 2 g/cm <sup>3</sup>	up to 2 g/cm <sup>3</sup>
Ø 110 mm	up to 1,8 g/cm <sup>3</sup>	up to 2 g/cm <sup>3</sup>	up to 2 g/cm <sup>3</sup>

## OPERATING TEMPERATURES\*\* AND WEIGHTS

PP (with glass additive)	from 0°C to + 70°C, 2,2 Kg*
PVDF (with carbon additive)	from -10°C to + 100°C, 2,5 Kg*

\*The weights refer to the pump without the motor

\*\*Measurements should be taken with agitated water; temperatures may vary depending on the conditions of the system and/or the processed liquid

## ELECTRIC MOTORS AVAILABLE ON REQUEST:

- Single-phase (up to 3 kw)
- ATEX
- NEMA 145TC\* / 184TC\*

\*(only pump available, with American flange, for coupling with NEMA motor - the motor is not available in our standard)

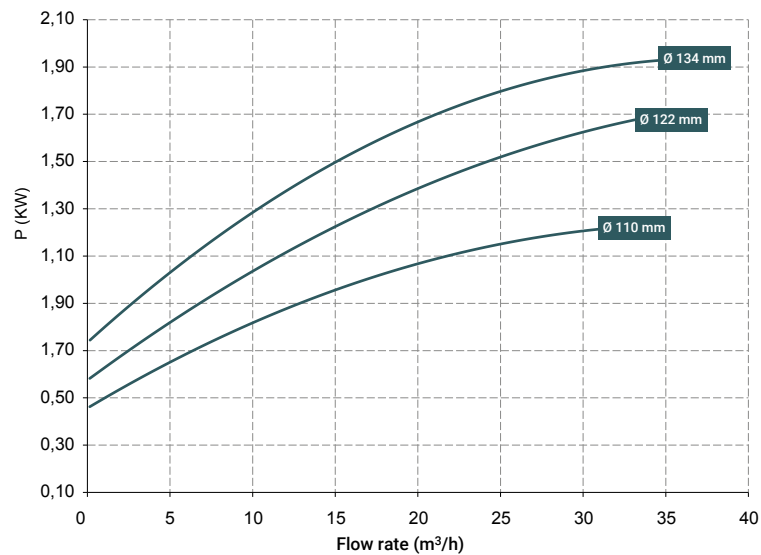
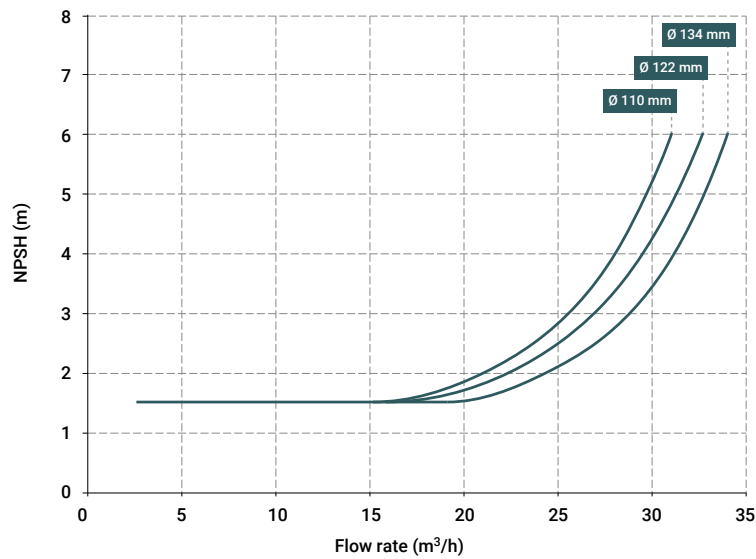
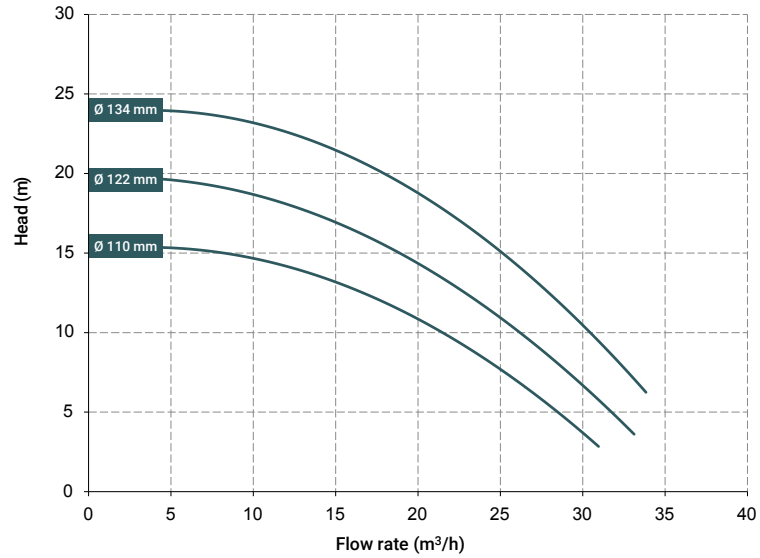

The curves and performances refer to tested pumps, with water at 20 °C, two-pole motor 50 Hz (2900rpm).

## Specifications and types

Length measurements in mm

MODEL	CASE	POWER	A	B	C	D	E*	F*	G*	H*	I	L	M	N*	O*	P*	Q*	R*	S*
DM 30	IEC 90	2,2 Kw	161,8	91	252,8	2" f(**)	200	195	90	138	140	1*1/2 m(**)	66,5	56	125	140	167	10	275
DM 30	IEC 100	3 Kw	161,8	91	252,8	2" f(**)	250	195	100	153	140	1*1/2 m(**)	66,5	63	140	160	194	12	314
DM 30	IEC 123	4 Kw	161,8	91	252,8	2" f(**)	250	195	112	169	140	1*1/2 m(**)	66,5	70	140	190	218	12	334
DM 30	NEMA 145TC***	3 Hp	161,8	91	252,8	2" f(**)	-	195	-	-	140	1*1/2 m(**)	66,5	-	-	-	-	-	-
DM 30	NEMA 184TC***	5 Hp	161,8	91	252,8	2" f(**)	-	195	-	-	140	1*1/2 m(**)	66,5	-	-	-	-	-	-

\* Measurements may vary depending on the motor supplier.

\*\* NPT or BSPP gas

\*\*\*Warning: if you decide to combine the pump with a NEMA motor, the pump is delivered with a suitable coupling flange, but not the NEMA motor, which is not included in our standard supply.

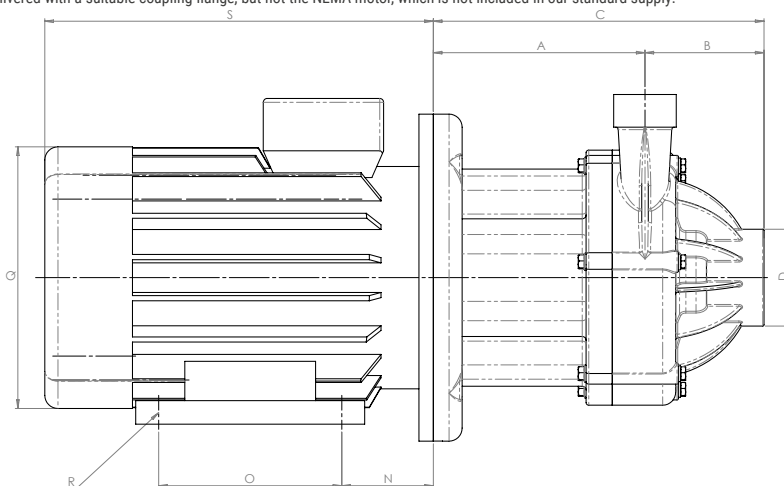
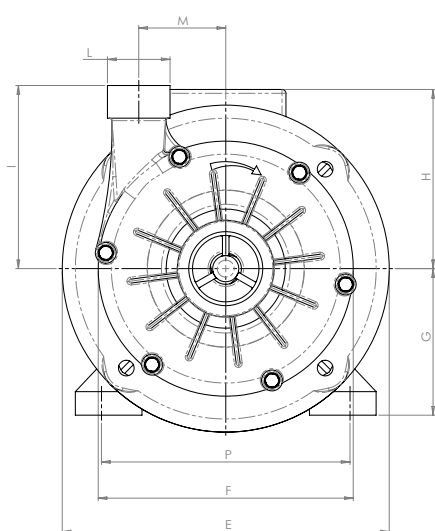

### Seal o-ring materials

- EPDM
- VITON®

### Packaging

- Pump with 2,2 Kw motor
- Wooden case size 61 x 28 x 42 cm - Weight 10 Kg (the weight refers only to the packaging without the pump inside)
- Pump with 3 Kw motor
- Wooden case size 64 x 28 x 42 cm - Weight 10 Kg (the weight refers only to the packaging without the pump inside)
- Pump with 4 Kw motor
- Wooden case size 69 x 36 x 46 cm - Weight 12 Kg (the weight refers only to the packaging without the pump inside)

### Accessories

- Flange kit (DIN flanges - ANSI on request)



UNDER HEAD USE