

# MB 110

## Specifications and types

Suction fittings	2" m BSPP or DN 50
Delivery fittings	1 1/2" m BSPP or DN 40
Max. flow rate	18 m <sup>3</sup> /h
Max. head	16 m
Viscosity up to	500 cps
Standard open impeller	Ø 130 mm H 4 mm *
Solids passing	Ø max 2 mm

\* Special versions are available on request for the fluid pumped



**PLASTIC MATERIAL  
PP**



**PLASTIC MATERIAL  
PVDF**



### MATERIALS OF CONSTRUCTION PUMP CASING, OPERATING TEMPERATURES\*\* AND NET WEIGHT

<b>POLYPROPYLENE (with glass additive)</b>	3.4 Kg*	Temp. 0°C min. +70°C max
<b>PVDF (with carbon additive)</b>	4.3 Kg*	Temp. -10°C min. +100°C max

\* The weights refer to the pump without the motor  
\*\*Measurements should be taken with agitated water; temperatures may vary depending on the conditions of the system and/or the processed liquid

### STANDARD ELECTRIC MOTOR:

Kw	1.1
HP	1.5
Constructive Form	B3 + B5
RPM	2900 / 3600
<b>Three-phase 230/400 V</b>	-
50/60 Hz	-
2 poles	-
Efficiency class	IE3
Protection	IP55
Ambient temperature	-30°C + 45°C
Aluminium/Cast iron	-
<b>Single-phase (up to 3 kw)</b>	on request
ATEX	on request

### TL = LIP SEAL

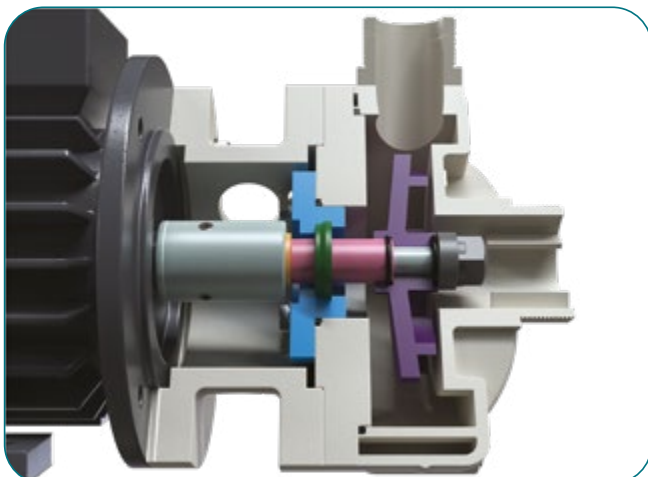

### TS = TBELLOWS SEAL

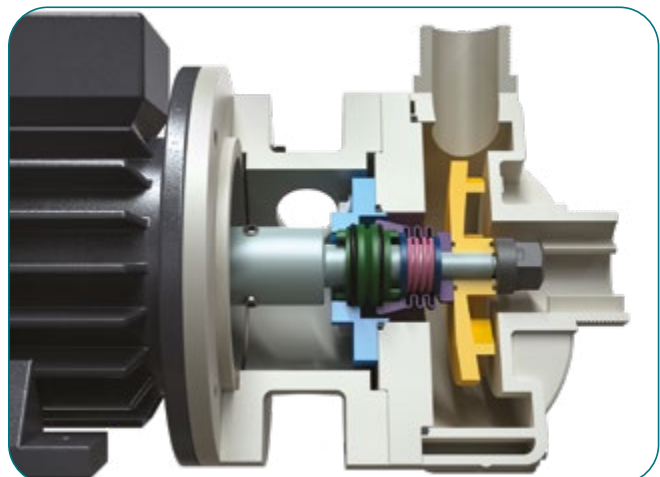

# MB 110

## Specifications and types

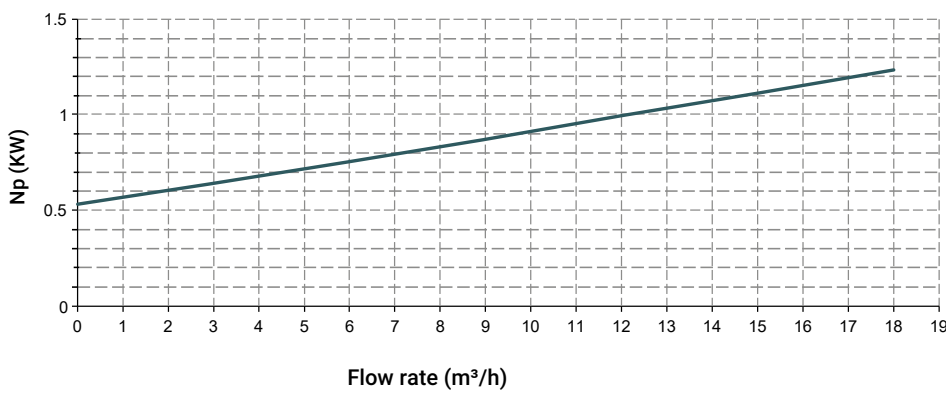
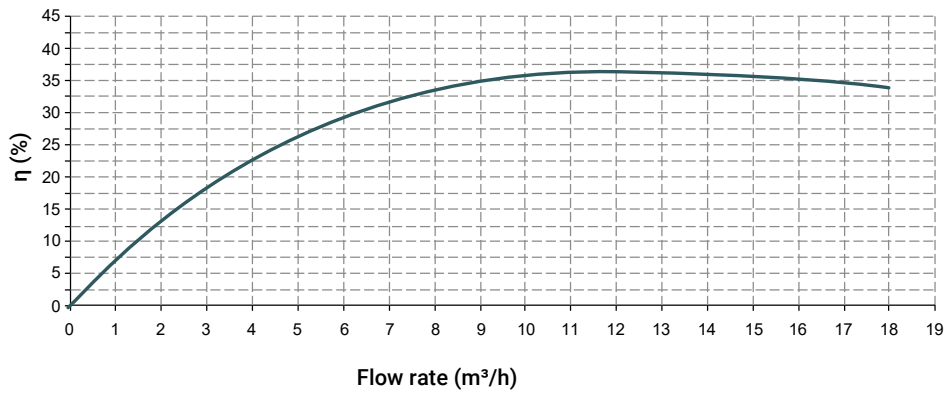
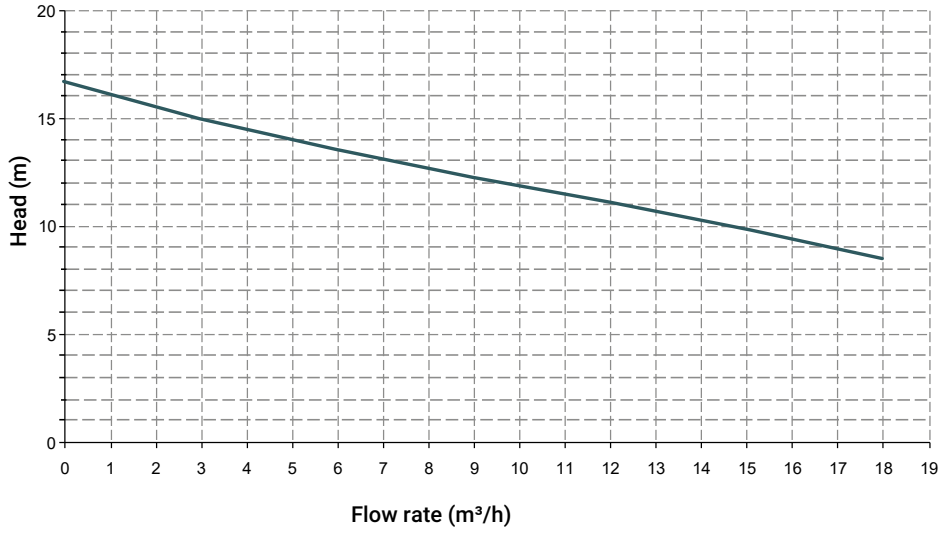

The curves and performances refer to tested pumps, with water at 20 °C, two-pole motor 50 Hz (2900rpm)

# MB 110

## Specifications and types

Length measurements in mm

MOD.	TEN.	POWER	Ø PASS. SOLIDS.	A	B	C	D	E	F	G	H	I	L	M	N	O	P	Q	R	S*
MB 110	TL - TS	1,1 KW - 1,5 HP	2	122	75	197	2" m(**) o DN 50	200	203	80	135	130	1"1/2 m (**) o DN 40	48	50	100	125	158	10	230

\* Measurements may vary depending on the motor supplier.

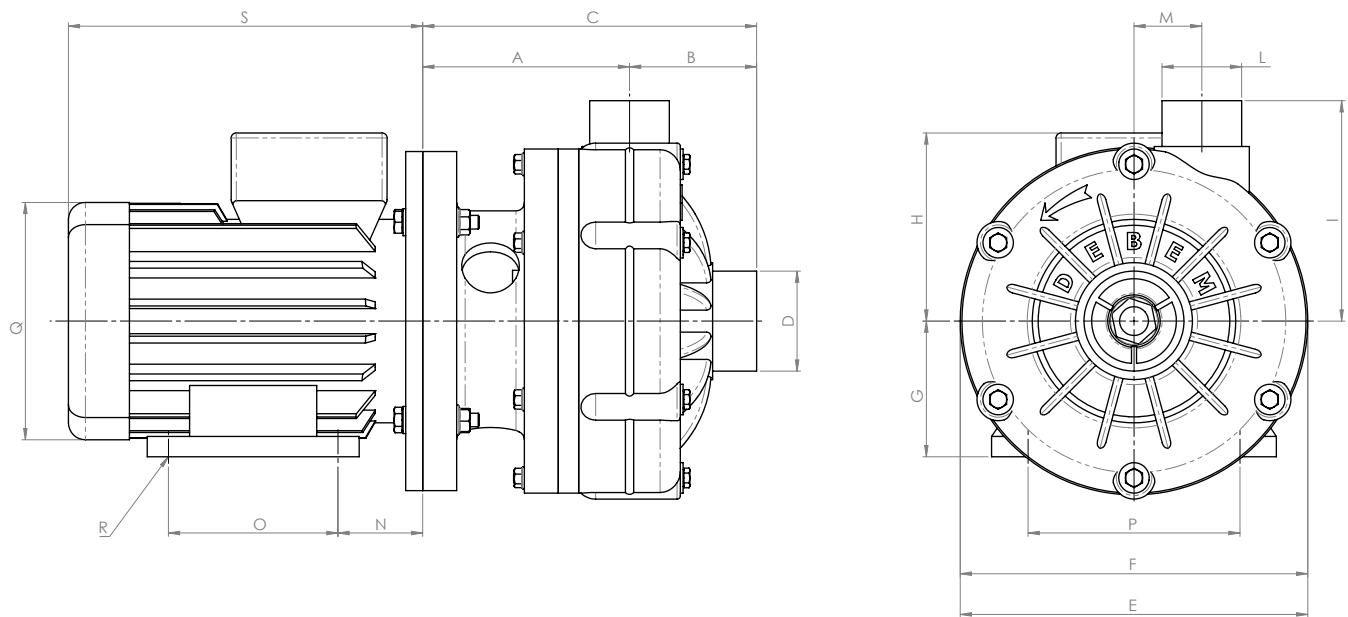

### Sealing O-ring materials

- EPDM
- VITON®

### Packaging

- Wooden case size cm 55 x 28 x 42 - Weight 10 Kg  
(the weight refers only to the packaging without the pump inside)

### Accessories

- FLANGE KIT (DIN standard - ANSI on request)
- Basket filter in Polypropylene or PVDF



UNDER HEAD USE