

MB 120

Specifications and types

Suction fittings	2" m BSPP or DN 50
Delivery fittings	1 1/2" m BSPP or DN 40
Max. flow rate	25 m ³ /h
Max. head	17 m
Viscosity up to	500 cps
Standard open impeller	Ø 120 mm H 8 mm *
Solids passing	Ø max 6 mm

* Special versions are available on request for the fluid pumped



**PLASTIC MATERIAL
PP**



**PLASTIC MATERIAL
PVDF**



MATERIALS OF CONSTRUCTION PUMP CASING, OPERATING TEMPERATURES** AND NET WEIGHT

POLYPROPYLENE (with glass additive)	3.8 Kg*	Temp. 0°C min. +70°C max
PVDF (with carbon additive)	4.9 Kg*	Temp. -10°C min. +100°C max

* The weights refer to the pump without the motor
**Measurements should be taken with agitated water; temperatures may vary depending on the conditions of the system and/or the processed liquid

STANDARD ELECTRIC MOTOR:

Kw	1.5
HP	2
Constructive Form	B3 + B5
RPttM	2900 / 3600
Three-phase 230/400 V	-
50/60 Hz	-
2 poles	-
Efficiency class	IE3
Protection	IP55
Ambient temperature	-30°C + 45°C
Aluminium/Cast iron	-
Single-phase (up to 3 kw)	on request
ATEX	on request

TL = LIP SEAL

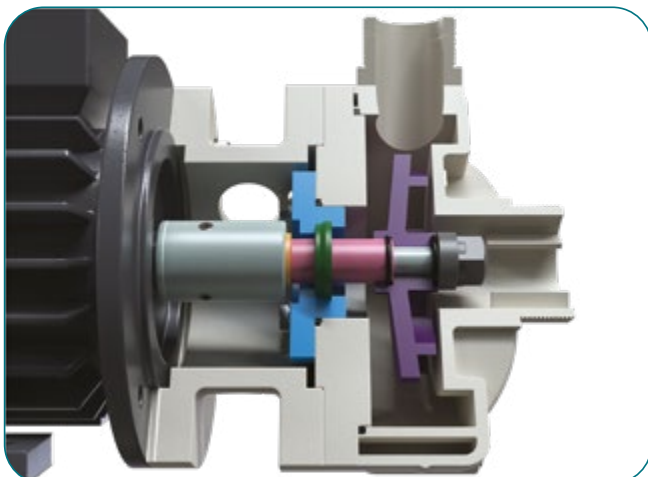

TS = TBELLOWS SEAL

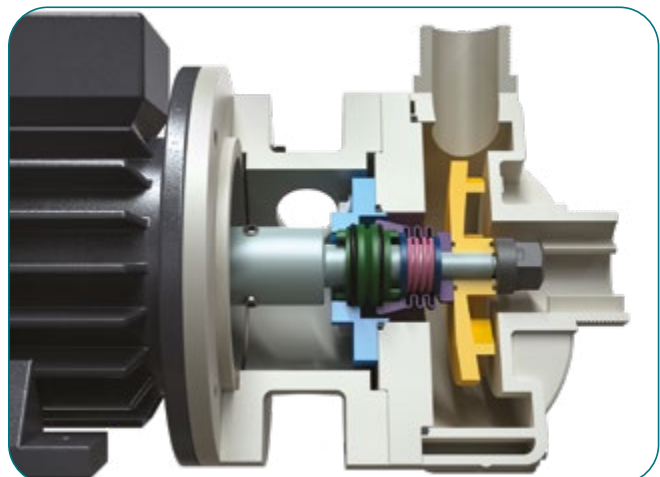

MB 120

Specifications and types

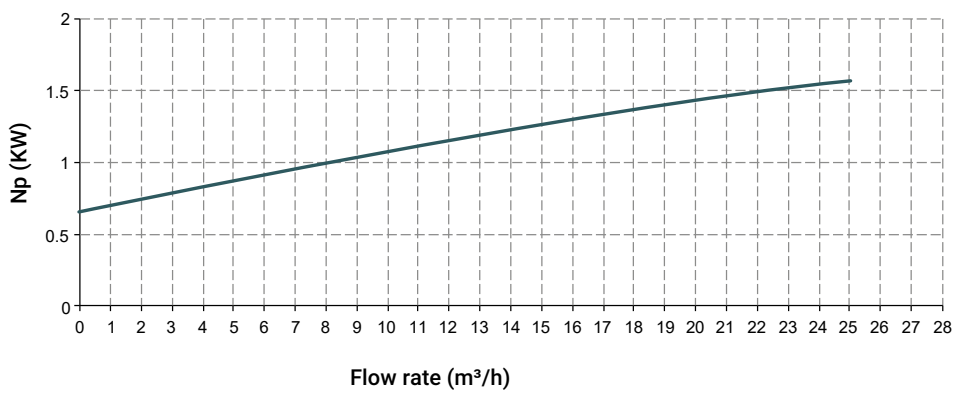
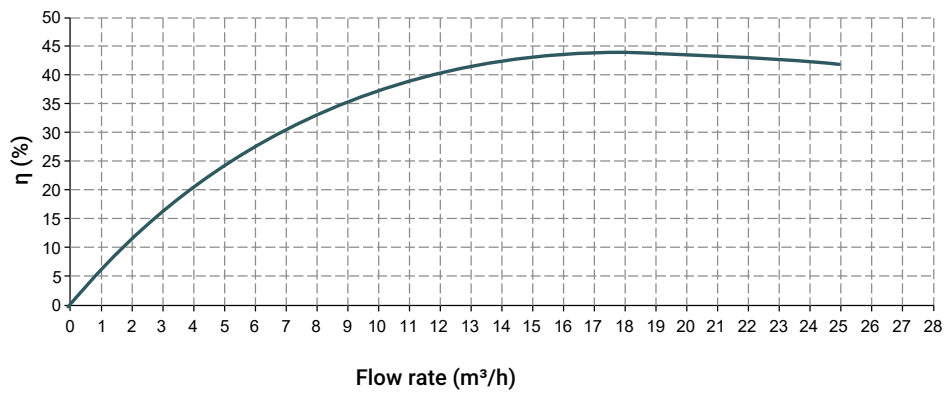
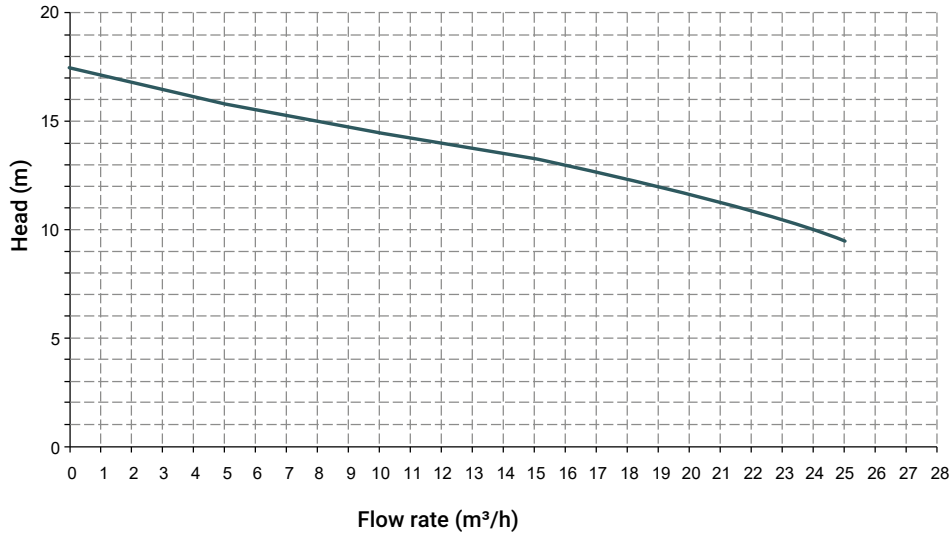

The curves and performances refer to tested pumps, with water at 20 °C, two-pole motor 50 Hz (2900rpm)

MB 120

Specifications and types

Length measurements in mm

MOD.	TEN.	POWER	Ø PASS. SOLIDS.	A	B	C	D	E	F	G	H	I	L	M	N	O	P	Q	R	S*
MB 120	TL	1,5 KW - 2 HP	6	136	75	211	2" m(**) o DN 50	200	203	80	135	130	1"1/2 m (**) o DN 40	40	50	100	125	158	10	230
MB 120	TS	1,5 KW - 2 HP	6	146	75	221	2" m(**) o DN 50	200	203	80	135	130	1"1/2 m (**) o DN 40	40	50	100	125	158	10	230

* Measurements may vary depending on the motor supplier.

SEAL TL

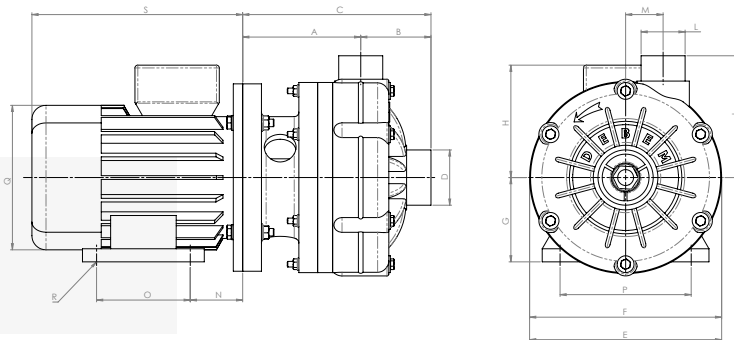

SEAL TS

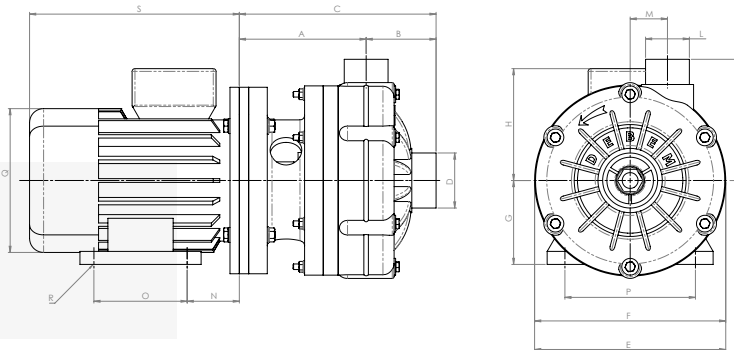

Sealing O-ring materials

- EPDM
- VITON®

Packaging

- Wooden case size cm 58 x 28 x 42 - Weight 10 Kg
(the weight refers only to the packaging without the pump inside)

Accessories

- FLANGE KIT (DIN standard - ANSI on request)
- Basket filter in Polypropylene or PVDF



UNDER HEAD USE